

ACS-E 6

Self centering
column chuck

Self-centering column chucks with pull down

Ø 200 - 450 mm

- pull down
- power operated via standard cylinders
- O.D. clamping

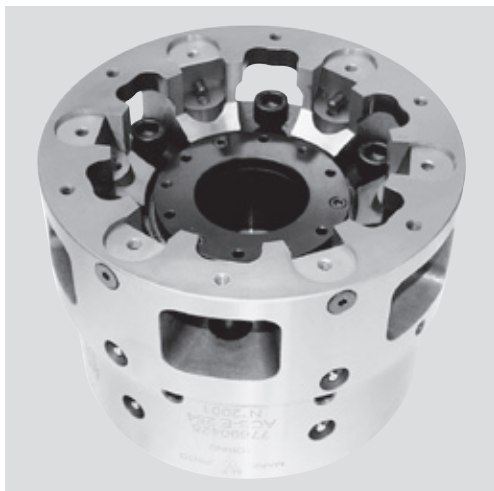

Application/customer benefits

- For small, medium and large quantities at high precision
- Pull down of the workpiece to the axial workstop during clamping
- Minimum loss of gripping force at high speed
- Standard, hardened jaw blanks available

Technical features

- Chuck body completely case hardened
- Openings in the chuck body to evacuate chips
- Central bore for coolant/air

Standard equipment

6-jaw chuck with mounting bolts

Ordering example

6 jaw column chuck
with center mounting Z170
type ACS-E 220-6-Z170

Actual gripping force diagram

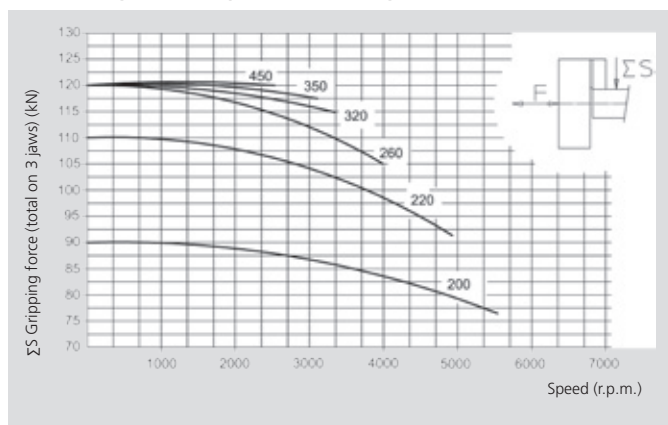

The diagrams refer to standard jaw blanks, machined to 50 % of their mass.

Technical data

SMW-AUTOBLOK Type		ACS-E 6 200	ACS-E 6 220	ACS-E 6 260	ACS-E 6 320	ACS-E 6 350	ACS-E 6 450
Jaw stroke	mm	2.6	3.2	4	6	6	6
Piston stroke	mm	10	12	15	15	15	15
Actuating force	kN	40	50	50	65	65	65
Grip force	kN	90	110	120	120	120	120
Speed	r.p.m.	5500	4900	4300	3400	3100	2200
Weight	kg	30	35	50	75	90	130
Moment of inertia	kg·m ²	0.16	0.21	0.35	0.84	1	3
Clamping range	min.	30	50	90	90	120	210
Clamping range	max.	100	125	165	215	245	335
Recommended actuating cylinders		SIN-S 100 SIN-S 125	SIN-S 125 SIN-S 150	SIN-S 125 SIN-S 150	SIN-S 125 SIN-S 150	SIN-S 125 SIN-S 150	SIN-S 125 SIN-S 150
Id. No. chuck		77690420	77690422	77690425	77690432	77690435	77690445
Id. No. jaw blanks		69762040	69762240			69763210	

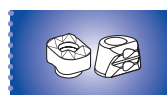

Page 330



Page 324

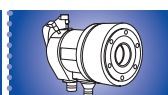

Page 225

Self-centering column chucks with pull down

Ø 200 - 450 mm

- pull down
- power operated via standard cylinders
- O.D. clamping

ACS-E 6

Self centering column chuck

ACS-E 450

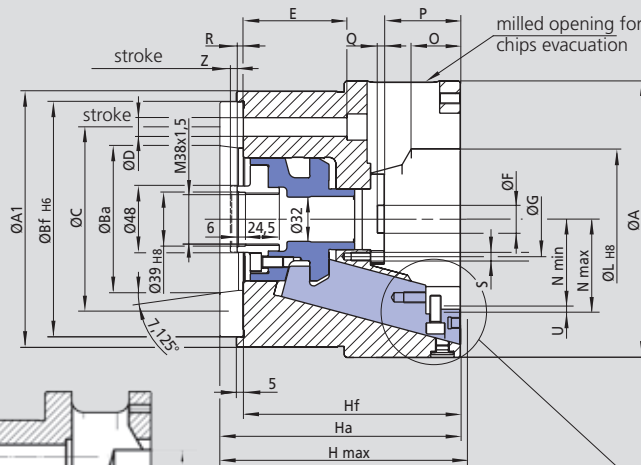
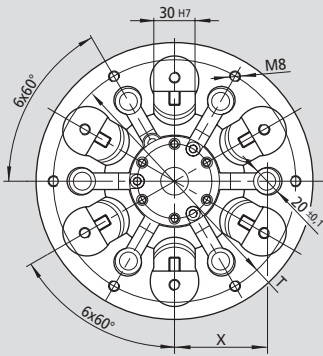

ACS-E 260

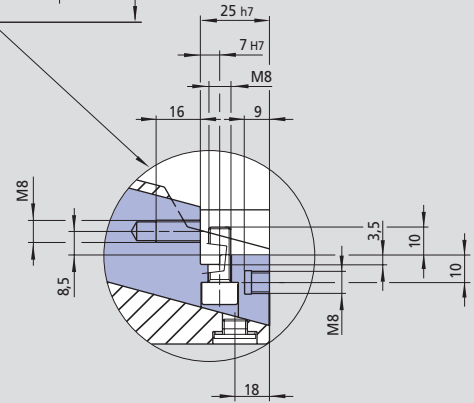
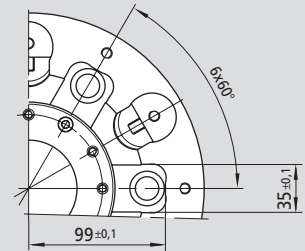

ACS-E 320-350-450

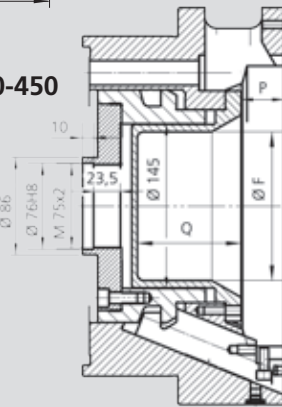

Subject to technical changes
For more detailed information please ask for customer drawing

4

SMW-AUTOBLOK Type ACS-E 6	200	220	260	320	350	450
Mounting	ISO-A6 Z170	ISO-A6 Z170	ISO-A8 Z220	ISO-A11 Z220	ISO-A11 Z220	ISO-A15 Z 220
A	200	220	260	324	354	450
A1	185	185	235	300	300	410
Ba	106.375	106.375	139.719	196.869	196.869	285.775
Bf	170	170	220	280	280	380
C	133.4	133.4	171.4	235	235	330.2
D	13	13	17	21	21	25
E	75	75	91	97	97	97
F	20	30	70	105	131	180
G	54	68	107	154	184	270
H max.	179	183	198.5	200.5	200.5	200.5
Ha	174	177	191	193	193	195
Hf	157	160	172	172	172	172
L	102	126	167	217	247	336
N min.	66.3	76.6	97	123	138	182
N max.	63.7	73.4	93	117	132	176
O	32	33	34	33	33	33
P	55	50.5	40	38	38	38
Q	7	7	65.5	91.5	91.5	90
R	4.5	3.5	2	6	6	6
S	6xM6	6xM6	6xM6	6xM6	6xM6	6xM6
T	175	190	226	290	320	405
U	2.6	3.2	4	6	6	6
Stroke Z	10	12	15	15	15	15
Stroke X	66.7	72	-	-	-	-
Stroke W	5	5	5	6	6	6

2 media can be used through the chuck's bore.

Specials on request.

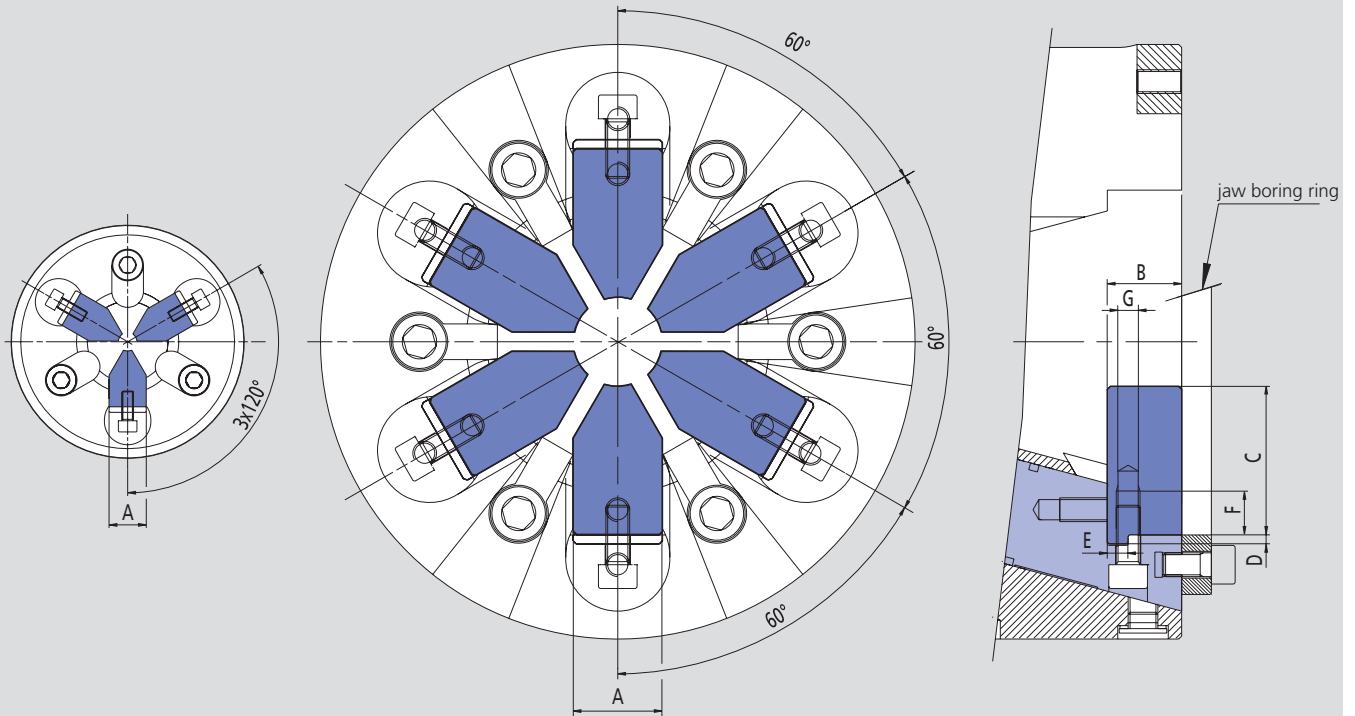

Material: 60MnSi4
HRC 56+2

Subject to technical changes
For more detailed information please ask for customer drawing

Technical data

SMW-AUTOBLOK Type	ACS-E 130	ACS-E 145	ACS-E 170	ACS-E 200	ACS-E 220	ACS-E 260	ACS-E 320	ACS-E 350	ACS-E 450	
Number of jaws	3	3	3	3-6	3-6	3-6	3-6	3-6	3-6	
A h6	20	20	20	30	30	30	30	30	30	
B	20	20	20	25	25	25	25	25	25	
C	30	35	40	50	50	50	75	75	75	
D	3	3	3	3	3	3	3	3	3	
E g6	6	6	6	7	7	7	7	7	7	
F	13	13	13	15	15	15	15	15	15	
G	M6	M6	M6	M8	M8	M8	M8	M8	M8	
rec. clamping range	min.	10	20	30	30	50	90	90	120	208
rec. clamping range	max.	50	70	95	100	125	165	215	245	335
Id. No. jaw blanks (1 set = 3 pcs.)	69761310	69761410	69761710	69762010	69762210	69762210	69763210	69763210	-	
Id. No. boring ring	69111310	69111410	69111710	69112040	69112240	69112540	69113240	69113540	69114540	

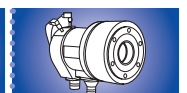
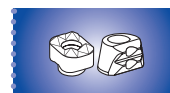

Examples

ACS-E

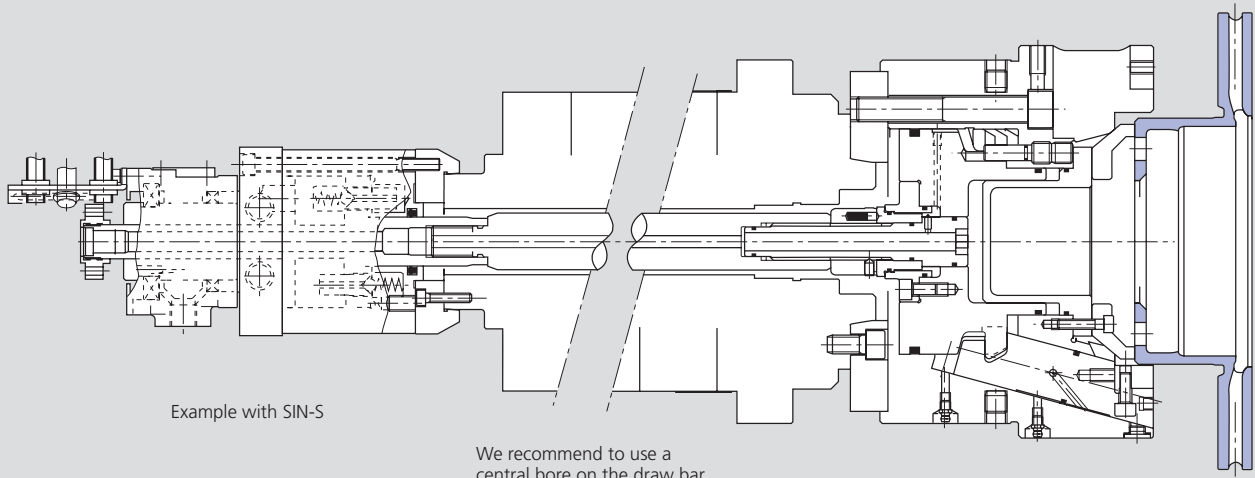

Subject to technical changes
For more detailed information please ask for customer drawing

ACS-I

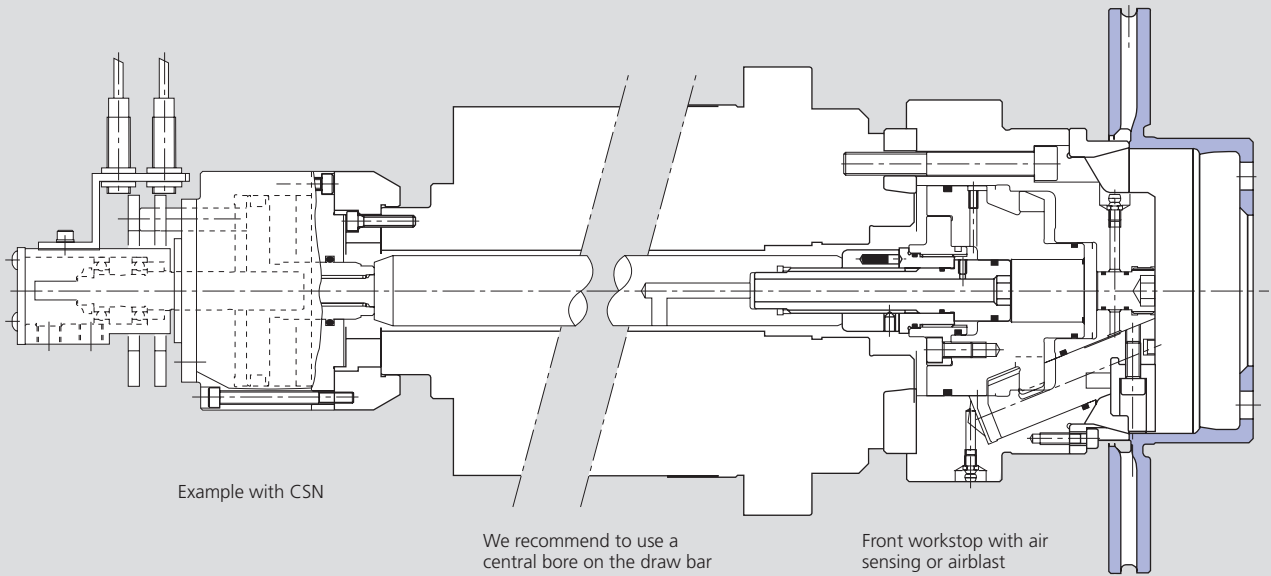

Subject to technical changes
For more detailed information please ask for customer drawing